



City of Willow Park
516 Ranch House Road
Willow Park, Texas 76087
Phone: (817) 441-7108 · Fax: (817) 441-6900

Drive Approach Application

Date ____/____/____

Permit Address: _____

Legal Description: Lot _____ Block _____ Addition _____

Property Use: Commercial _____ Residential _____

I have owner's consent to perform this work? Yes _____ No _____

Property Owner Information

Owner Name _____ Company Name _____

Address _____

Phone _____ - _____ - _____ Fax _____ - _____ - _____

Email _____ Mobile _____ - _____ - _____

Contractor Information

Owner Name _____ Company Name _____

Address _____

Phone _____ - _____ - _____ Fax _____ - _____ - _____

Email _____ Mobile _____ - _____ - _____

Permit Requirements

- 1) Applicant must provide PLAT/ SURVEY showing driveway layout, including location and dimensions.
- 2) Drive approach must be designed in accordance with City of Willow Park construction standards.
- 3) Drive approach shall be inspected prior to pouring concrete.
- 4) Permit Inspection Fee \$ 100.00

Applicant Signature: _____ Date: ____/____/____

Printed Name: _____

PRINTED BY: SUE ANN BOND PLOTTED ON: 8/11/2015 1:34 PM X:\C\WILLOW_PARK\MISC\WP_STANDARD_DETAILS\500.WP STANDARD DETAILS - STREET\WP_STREET_01.DWG

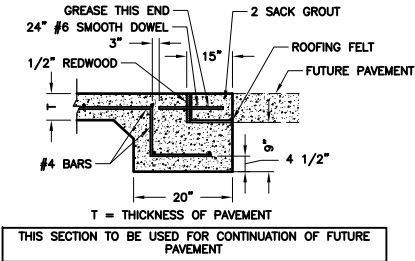

CONCRETE PAVEMENT HEADER DETAIL
N.T.S.

DATE: JUNE, 2015

STANDARD DETAIL: 510

NO ADDITIONS OR CHANGES SHALL BE MADE TO THE STANDARD DETAIL SHEETS UNLESS APPROVED BY THE CITY OF WILLOW PARK.

CITY OF WILLOW PARK,
PARKER COUNTY, TEXAS
516 Ranch House Road * Willow Park, Texas 76087
Phone: 817-441-7108 * Fax: 817-441-6900

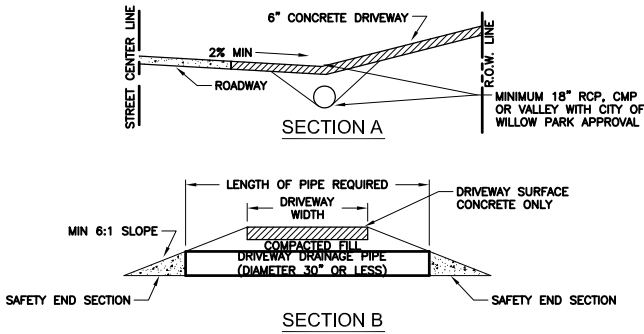
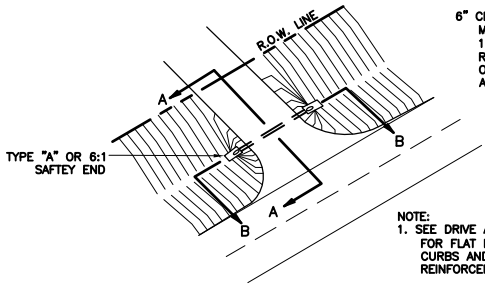

STANDARD DRIVEWAY APPROACH
WITH CULVERT
N.T.S.

DATE: JUNE, 2015

STANDARD DETAIL: 532

NO ADDITIONS OR CHANGES SHALL BE MADE TO THE STANDARD DETAIL SHEETS UNLESS APPROVED BY THE CITY OF WILLOW PARK.

CITY OF WILLOW PARK,
PARKER COUNTY, TEXAS
516 Ranch House Road * Willow Park, Texas 76087
Phone: 817-441-7108 * Fax: 817-441-6900

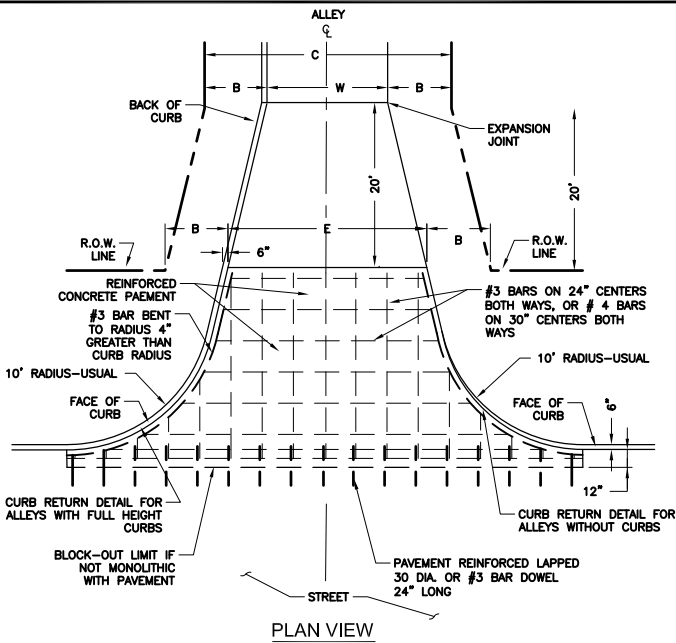

ALLEY WIDTH (W)	R.O.W. WIDTH (C)	B	E
10'	15'	2'-6"	12'
12'	17'	2'-6"	14'
16'	21'	2'-6"	18'
20'	25'	2'-6"	22'

ALLEY APPROACH
RADIUS RETURN TYPE
N.T.S.

DATE: JUNE, 2015

STANDARD DETAIL: 535

NO ADDITIONS OR CHANGES SHALL BE MADE TO THE STANDARD DETAIL SHEETS UNLESS APPROVED BY THE CITY OF WILLOW PARK.

CITY OF WILLOW PARK,
PARKER COUNTY, TEXAS
516 Ranch House Road * Willow Park, Texas 76087
Phone: 817-441-7108 * Fax: 817-441-6900

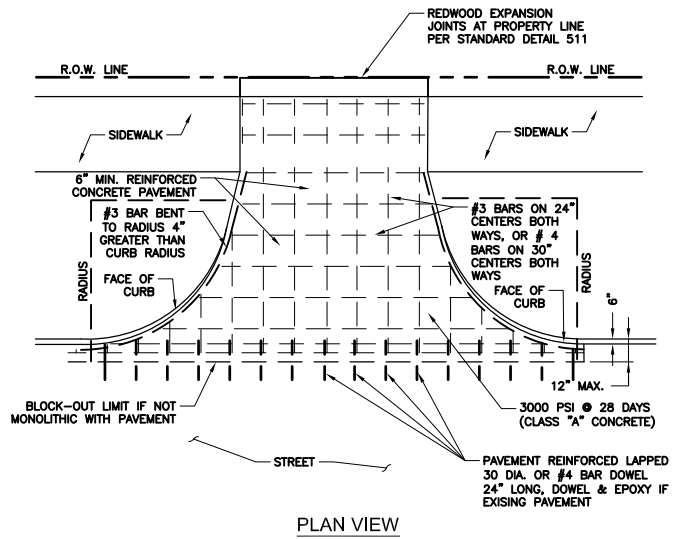

- NOTES:
1. DRIVEWAY SHALL NOT HAVE GREATER THAN 12% SLOPE.
 2. IF SIDEWALK IS AT THE RADIUS, THE 6" SIDEWALK SHALL BE POURED MONOLITHICALLY WITH THE DRIVEWAY ONE JOINT EITHER SIDE.

DRIVEWAY APPROACH
RADIUS RETURN TYPE
N.T.S.

DATE: AUG, 2015

STANDARD DETAIL: 531

NO ADDITIONS OR CHANGES SHALL BE MADE TO THE STANDARD DETAIL SHEETS UNLESS APPROVED BY THE CITY OF WILLOW PARK.

CITY OF WILLOW PARK,
PARKER COUNTY, TEXAS
516 Ranch House Road * Willow Park, Texas 76087
Phone: 817-441-7108 * Fax: 817-441-6900

REVISIONS:

CITY OF WILLOW PARK, PARKER COUNTY, TEXAS
516 Ranch House Road
Willow Park, Texas 76087
Phone: 817-441-7108 - Fax: 817-441-6900

CITY OF WILLOW PARK, TEXAS

STANDARD DETAILS

22x34 SCALE:	N.T.S.
11x17 SCALE:	N.T.S.
DATE	AUG 2015
DRAWN	X.X.X.
CHECKED	X.X.X.
APPROVED	X.X.X.

NO ADDITIONS OR CHANGES SHALL BE MADE TO THE STANDARD DETAIL SHEETS UNLESS APPROVED BY THE CITY OF WILLOW PARK.

SHEET TITLE:

STREET DETAILS

SHEET NO.: C-ST03